

CG20.200 FD

DOUBLE-ACTING **LINK CLAMP CYLINDER**

MAX. OPERATING PRESSURE = 200BAR

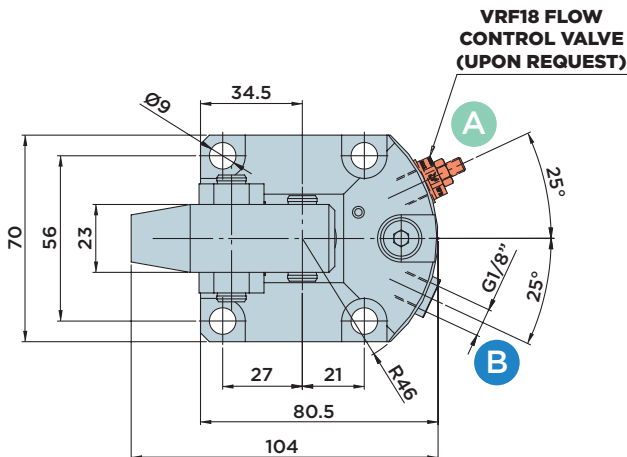
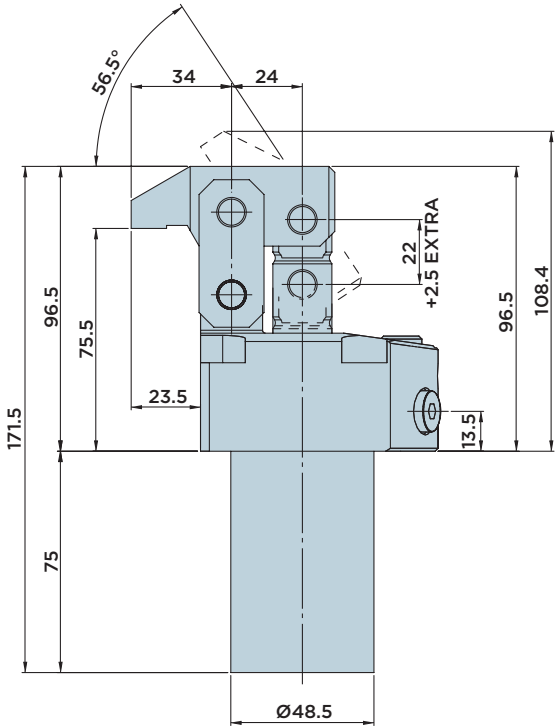
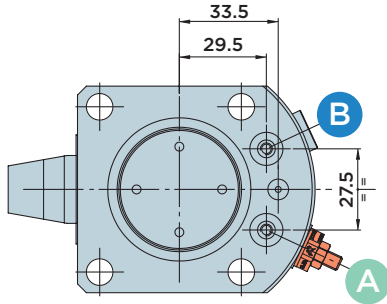
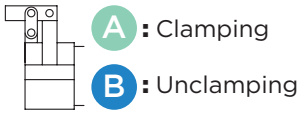

INSTALLATION DIMENSIONS

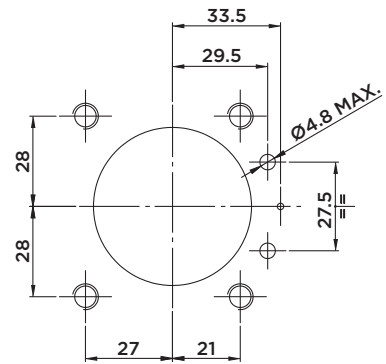
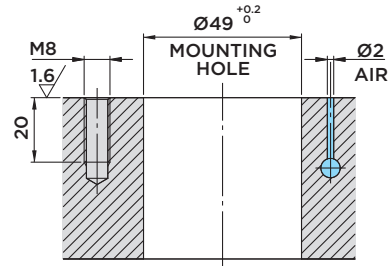

Included in the scope of supply:

- Mounting screws M8x45 DIN 912/12.9 grade.
- O-rings Ø4.34x3.53

Material:

- Piston/rod/bolts: Case-hardened steel, ground.
- Body: Free machining steel, nitrocarburized.
- Lever: Quenched and Tempered steel.
- Clamp arm: C45.

Options:

- Upon request, different clamp arm types can be manufactured to customer specification, mounted and commissioned.
- The link clamp cylinder can also be ordered without clamp arm (order no. CG20.200FDN).
- The link clamp cylinder can also be ordered with VRF18 flow control valve (order no. CG20.200FDS).

STROKE mm	EFFECTIVE PISTON AREA		TOTAL OIL VOLUME	
	Cm ²		Cm ³	
	CLAMP.	UNCLAMP.	CLAMP.	UNCLAMP.
TOTAL 24.5	9.08	5.94	22.2	14.6



HYDROBLOCK

CG20.200 FS

SINGLE-ACTING **LINK CLAMP CYLINDER**

MAX. OPERATING PRESSURE = 200BAR

A : Clamping

B : Venting

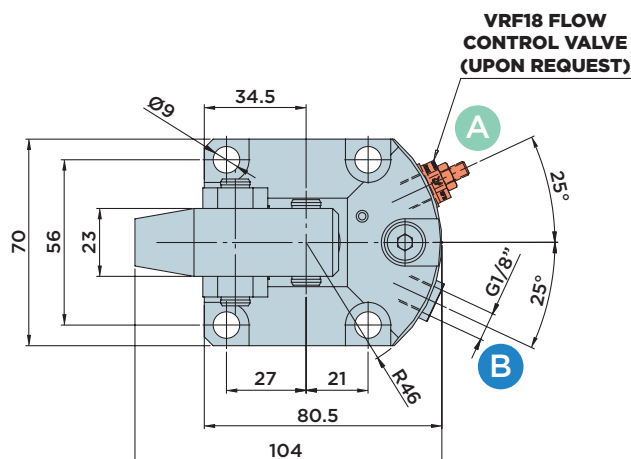
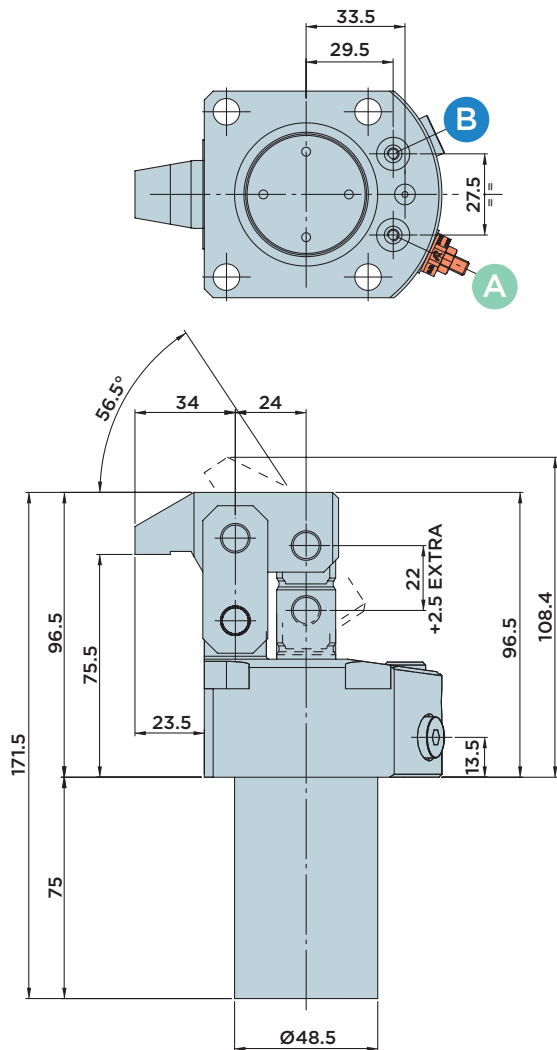

INSTALLATION DIMENSIONS

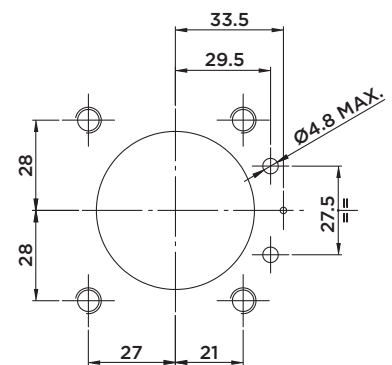
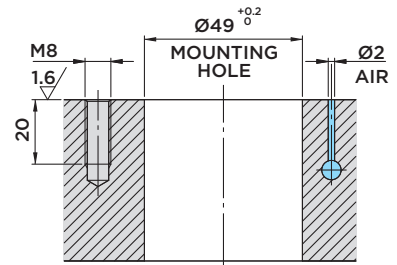

Included in the scope of supply:

- Mounting screws M8x45 DIN 912/12.9 grade.
- O-rings Ø4.34x3.53

Material:

- Piston/rod/bolts: Case-hardened steel, ground.
- Body: Free machining steel, nitrocarburized.
- Lever: Quenched and Tempered steel.
- Clamp arm: C45.

Options:

- Upon request, different clamp arm types can be manufactured to customer specification, mounted and commissioned.
- The link clamp cylinder can also be ordered without clamp arm (order no. CG20.200FSN).
- The link clamp cylinder can also be ordered with VRF18 flow control valve (order no. CG20.200FSS).

STROKE mm	EFFECTIVE PISTON AREA	TOTAL OIL VOLUME
	Cm ²	Cm ³
TOTAL 24.5	CLAMP.	CLAMP.
	9.08	22.2



HYDROBLOCK