

# IRFP 16S

CILINDRO IRRIGIDITORE ANTIVIBRANTE CON **CORPO FILETTATO**

PRESSIONE MASSIMA = 350BAR

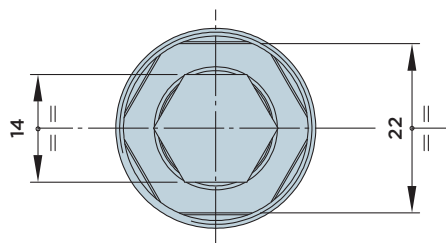
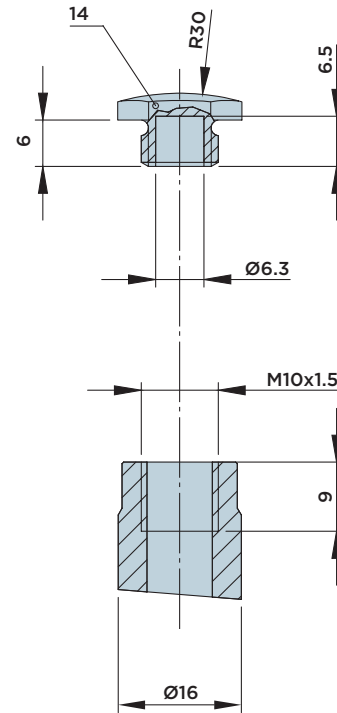
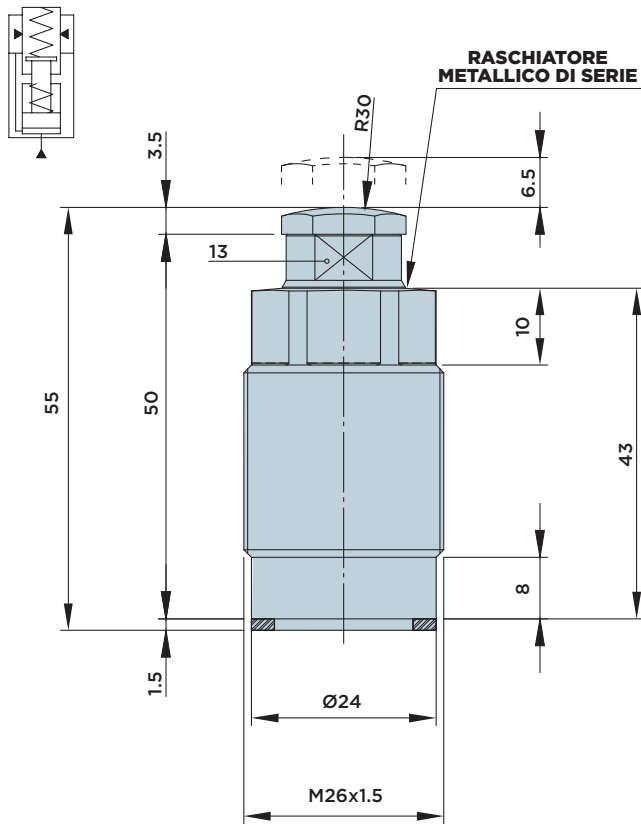

## DIMENSIONI INSTALLAZIONE

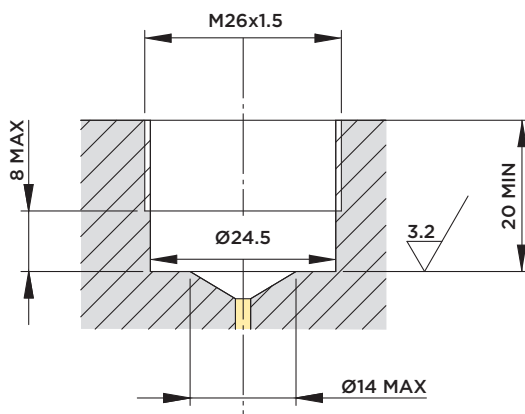

## DIAGRAMMA FORZA/PRESSIONE/FLESSIONE

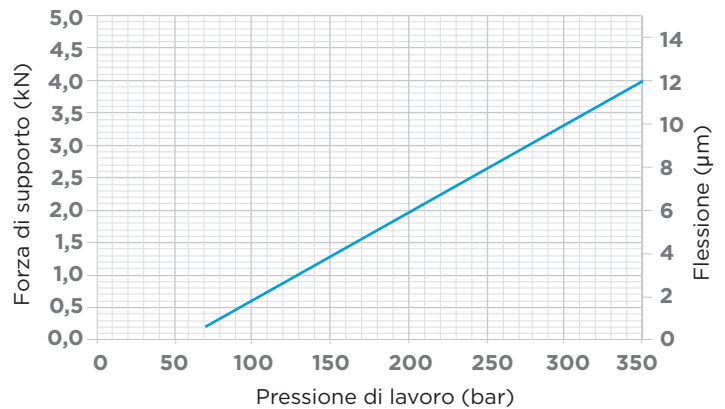

### Note:

Flusso volumetrico massimo ammesso in alimentazione cilindro 1.5 l/min.

### Forza di accostamento:

- Standard 15÷25 N

### Forniti a corredo:

- Anello di tenuta  $\varnothing 18 \times \varnothing 24 \times 1.5$

### Materiali:

- Stelo: acciaio da cementazione indurito e rettificato.
- Corpo: acciaio da macchine automatiche nitrocarburato.



HYDROBLOCK

# IRFM 16S

CILINDRO IRRIGIDITORE ANTIVIBBRANTE CON **CORPO FILETTATO**

PRESSIONE MASSIMA = 350BAR

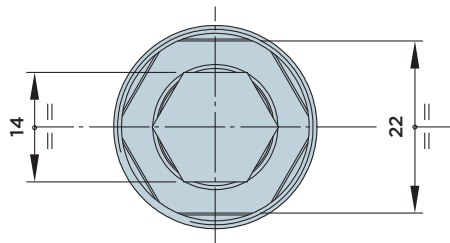
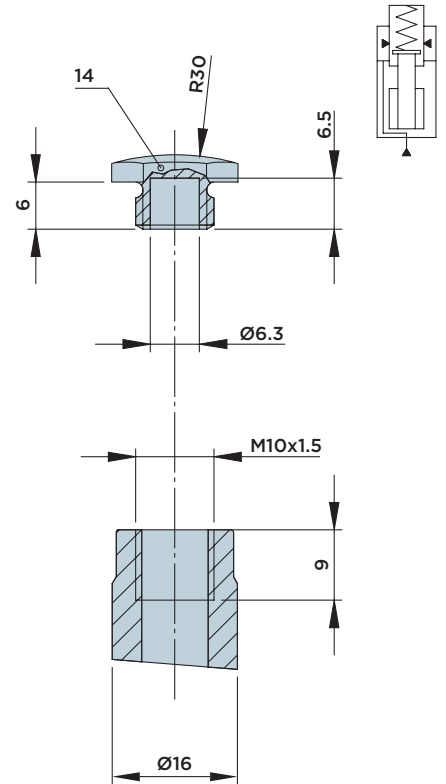
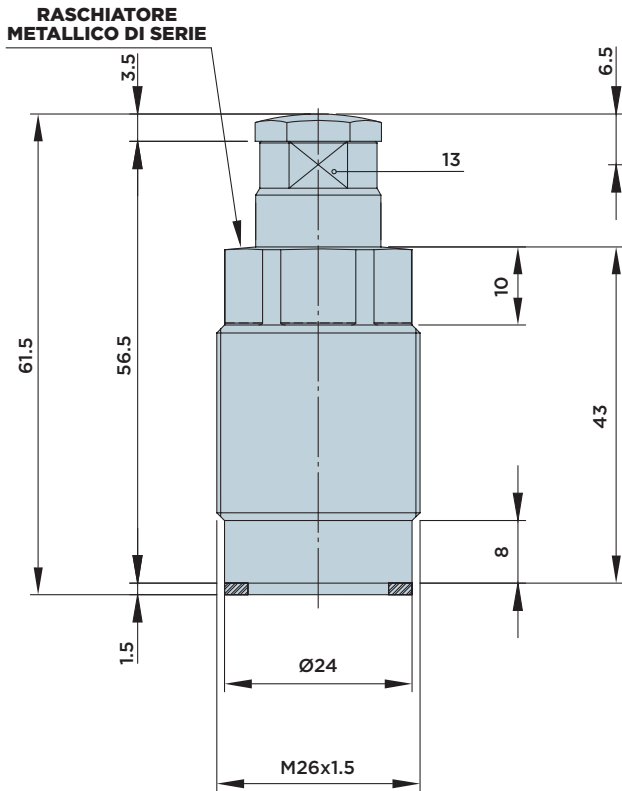

## DIMENSIONI INSTALLAZIONE

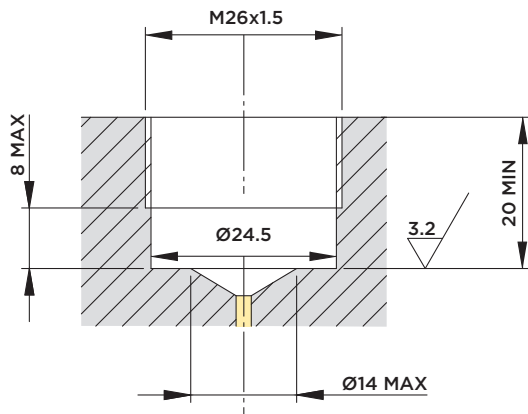

## DIAGRAMMA FORZA/PRESSIONE/FLESSIONE

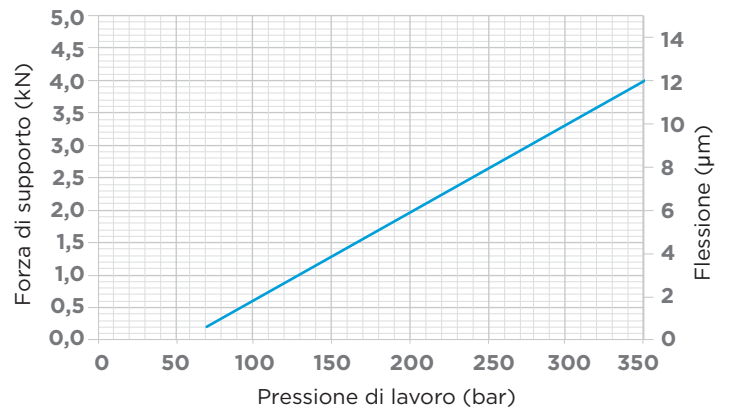

### Note:

Flusso volumetrico massimo ammesso in alimentazione cilindro 1.5 l/min.

### Forza di accostamento:

- Standard 15÷25 N

### Forniti a corredo:

- Anello di tenuta Ø18xØ24x1.5

### Materiali:

- Stelo: acciaio da cementazione indurito e rettificato.
- Corpo: acciaio da macchine automatiche nitrocarburato.



HYDROBLOCK