





# CG12.250 FM

DOUBLE-ACTING **LINK CLAMP CYLINDER**

MAX. OPERATING PRESSURE = 250BAR

**A** : Clamping

**B** : Unclamping

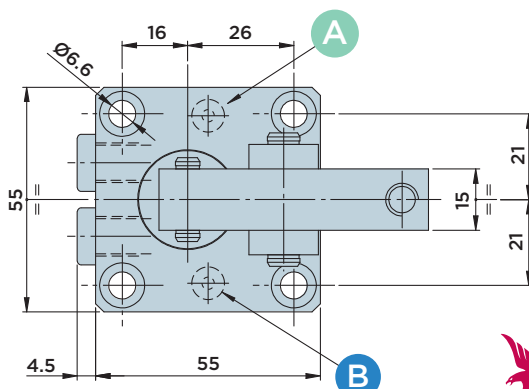
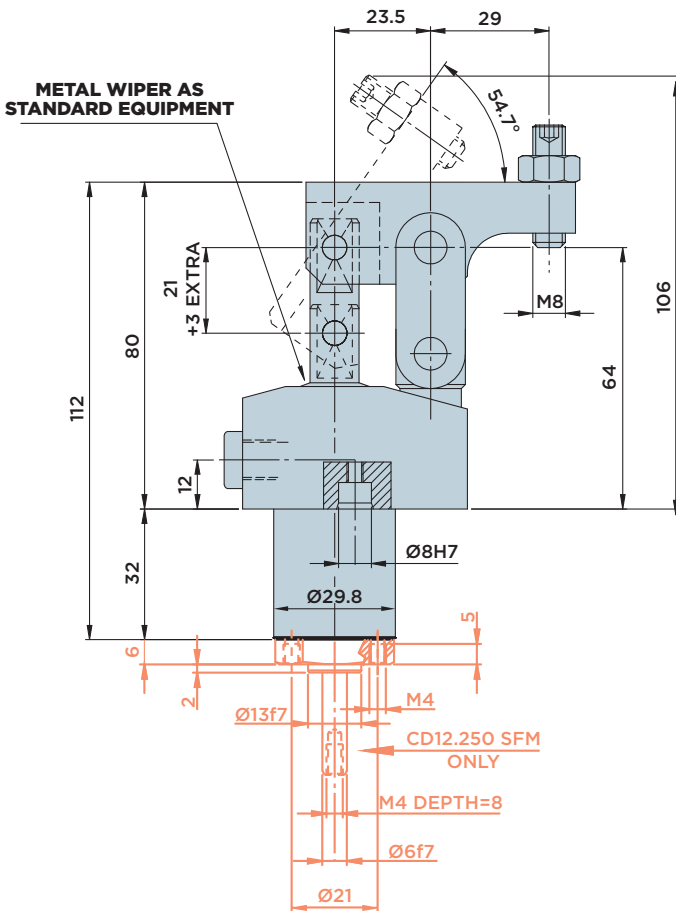
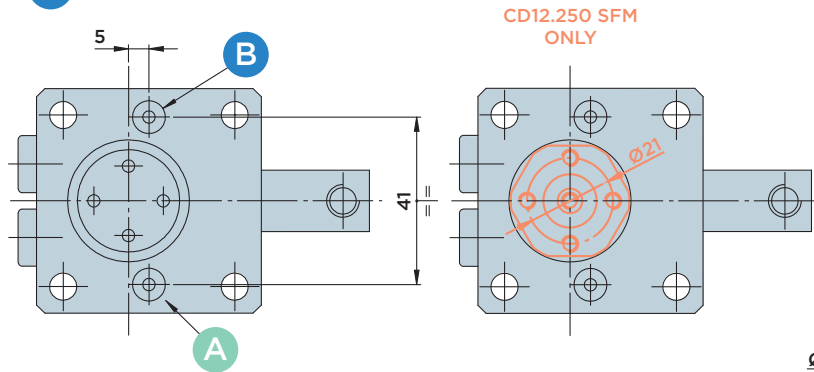

## INSTALLATION DIMENSIONS

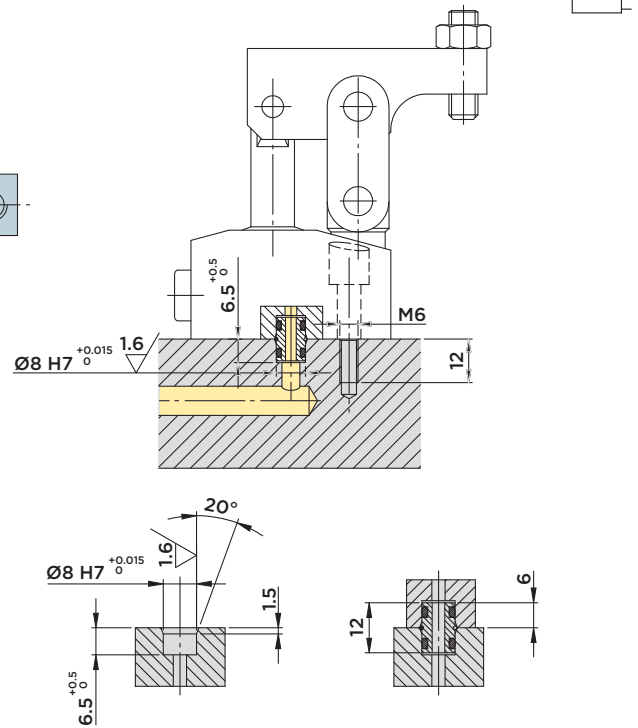

### Included in the scope of supply:

- Mounting screws M6x25 DIN 912/12.9 grade.
- Hydraulic plug connector Ø8x12.

### Material:

- Piston/rod/bolts: Case-hardened steel, ground.
- Body: Free machining steel, nitrocarburized.
- Lever: Quenched and Tempered steel.
- Clamp arm: C45.

### Options:

- Upon request, different clamp arm types can be manufactured to customer specification, mounted and commissioned.
- The link clamp cylinder can also be ordered without clamp arm (order no. CG12.250FMN).
- The cylinder is also available with position control sensor (order no. CG12.250SFM).
- The cylinder can also be ordered with position control sensor but without clamp arm (order no. CG12.250SFMN).

STROKE mm	EFFECTIVE PISTON AREA		TOTAL OIL VOLUME	
	Cm <sup>2</sup>		Cm <sup>3</sup>	
	CLAMP.	UNCLAMP.	CLAMP.	UNCLAMP.
<b>TOTAL</b> 24	2.01	0.88	4.8	2.1